

E68 Opening Window System

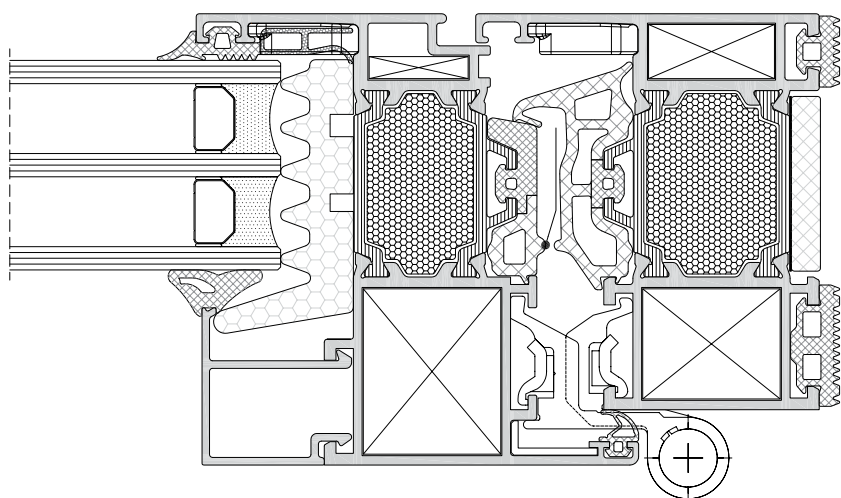

A window system with a range of energy conservation and performance options. The flat design and concealed sash profile ensure the system caters to most modern aesthetic concepts.



Technical features

- Variety of profiles and gaskets combination
- Min. height (frame+vent): 107mm
- Compatible with curtain wall system
- Double & triple glazing option
- Glazing infill: up to 48mm in frame
- Fixed frame (min. depth): 68 mm
- Vent frame (min. depth): 77,5 mm
- Hidden vent
- Energy efficiency concepts: High+, High, Standard+, Standard

Performance

Air Permeability:	up to Class 4
Watertightness:	up to class E1500
Resistance to wind load:	up to class C5
Thermal transmittance (U_p):	from 1,7 W/(m²K)
Acoustic performance:	up to 44 dB

Hardware

- Eurogroove & PVC groove
- Max. vent weight: 170kg

Surface treatment options

- RAL colours
- ETEM colours
- Anodising
- Wood effects
- Quality Standards:
 - QUALICOAT
 - QUALANOD
 - QUALIDECO

Typologies

- Turn, tilt & turn, tilt, projecting, folding, fixed, parallel sliding, door-height window
- Single & double leaf
- Inward opening

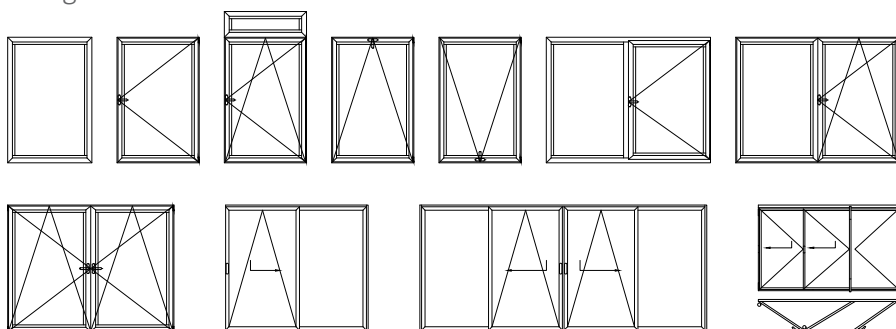

Production certificates

- EN ISO 9001
- EN ISO 14001
- OHSAS 18001